



SW 20-C / SW 35-C / SW 20-light

D	Streuwagen	Deutsch	4
GB	Spreader	English	5
F	Épandeurs	Français	6
I	Spargitori	Italiano	7
E	Carros esparcidores	Español	8
CZ	Posypový vůz	Česky	9
DK	Strøvogn	Dansk	10
EST	Puistekäru	Eesti	11
H	Szórókocsi	Magyar	12
N	Strøvogn	Norsk	13
NL	Strooiwagen	Nederlands	14
P	Carrinho de dispersão	Português	15
PL	Wózek do sypania	Polski	16
RO	Cărucior de împrăștiat	Română	17
RUS	Колесный разбрасыватель	Русский	18
S	Spridare	Svenska	19
SF	Hiekoitusvaunu	Suomi	20
SK	Posypový vozík	Slovenčina	21
SLO	Voziček za posipanje	Slovensko	22
TR	Serpme aracı	Türkçe	23



SW 20-light



SW 35-C

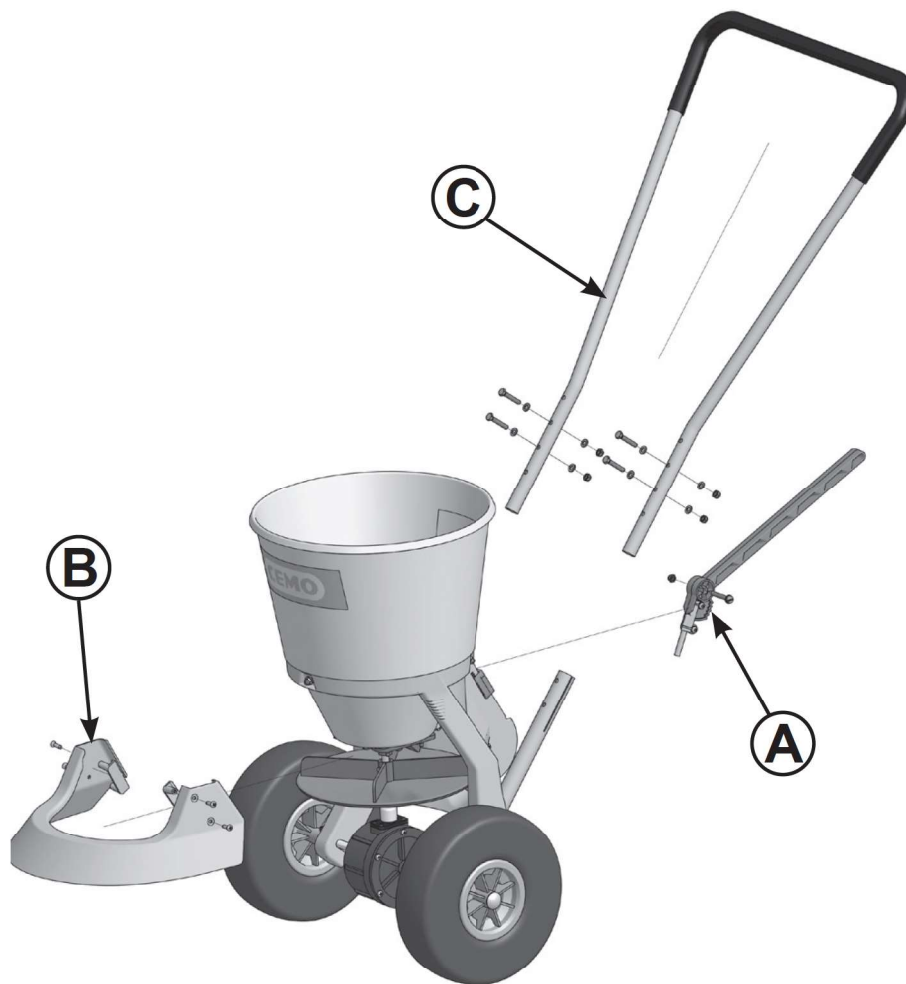

A (SW 20-C + SW 20-light)

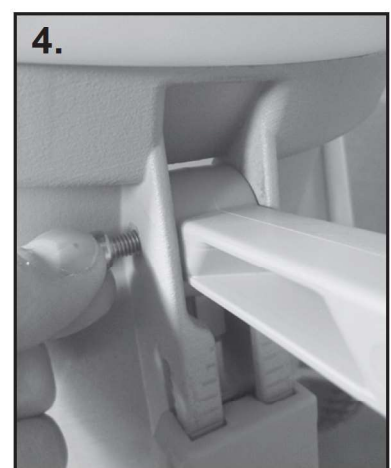
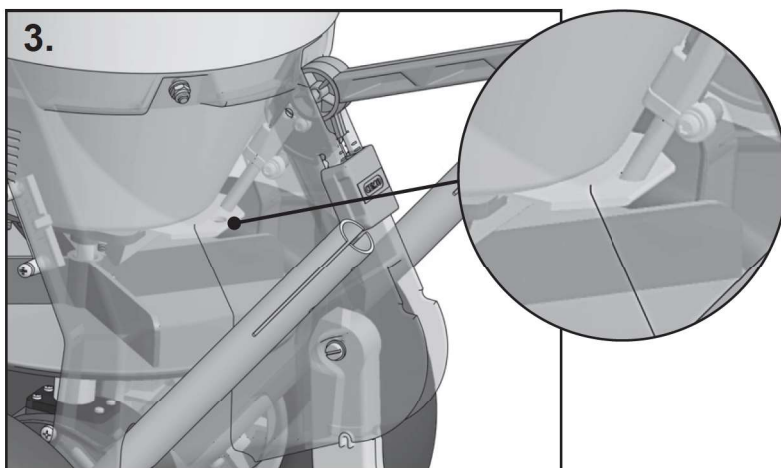
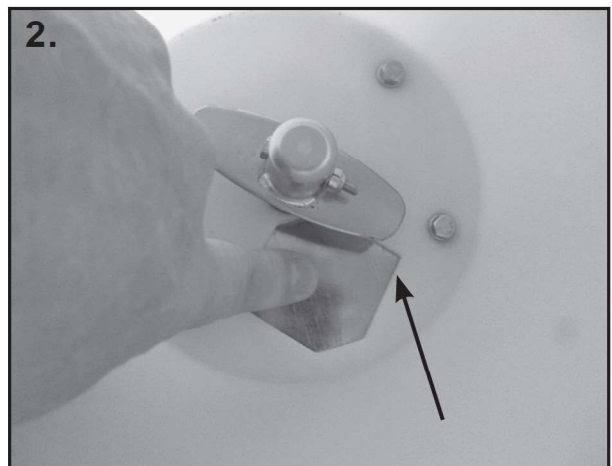
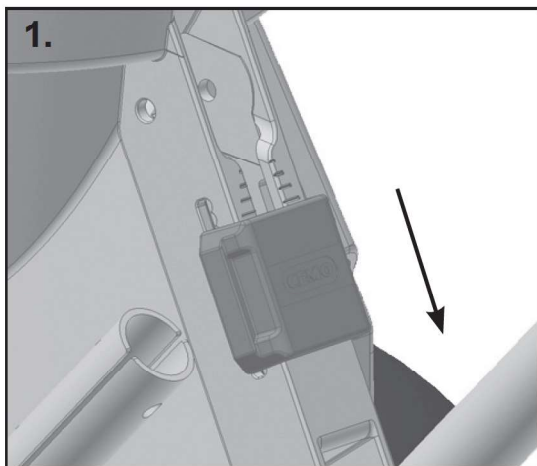

B (SW 20-C)

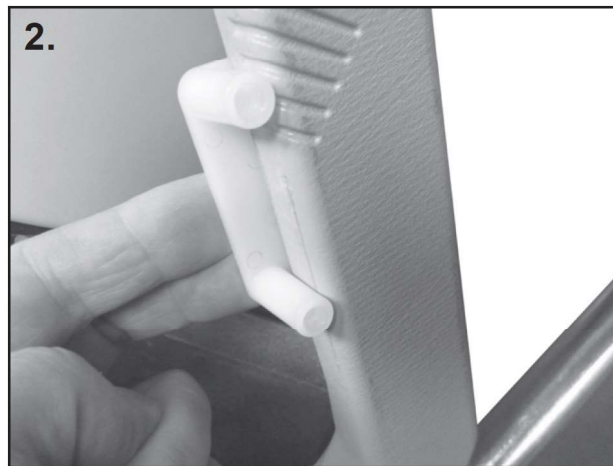
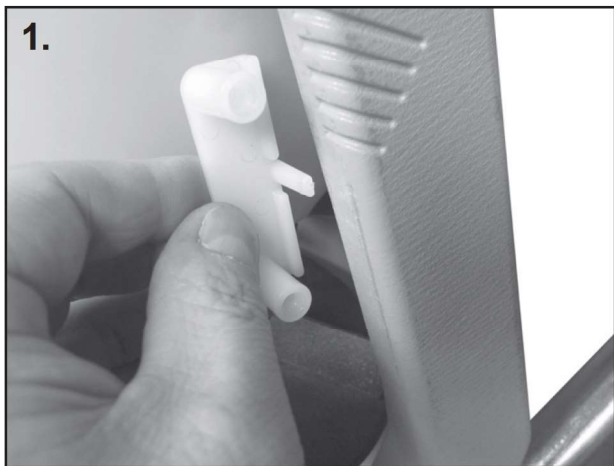

C (SW 20-C + SW 35-C + SW 20-light)

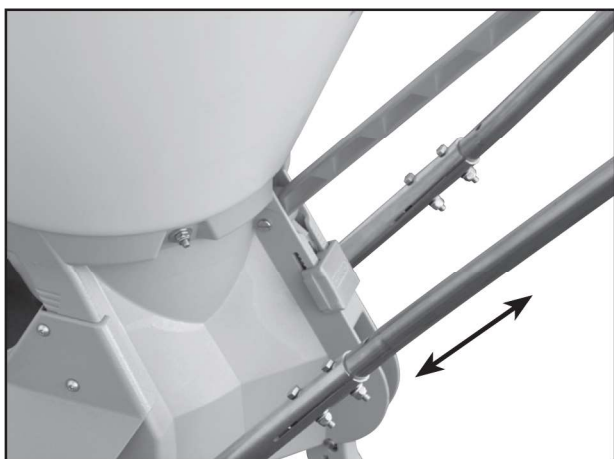

Spreading table

Spread volume in g/m²

Spread width: 3 m

Travel speed: 5 km/hours

Aperture position	Grit (3.5)	Salt
½	12	6
¾	35	13
1	55	20

Note: The spread volume listed in g/m² has been measured at a spread width of 3 m and a travel speed of approx. 5 km/hours (3.1 mph). The values listed are guide values; actual values may differ considerably depending on the characteristics of the material spread. The area of spreading varies with the travel speed, and the values should be recalculated accordingly.

Recommendation: To determine the exact spread volume, we recommend carrying out a calibration spread, e.g. spreading along a measured path.

Gritting material

The SW 20-C, SW 35-C and SW 20-light spreaders are particularly suitable for spreading salt, sand and gravel on paths, roads, schoolyards, parking areas, etc. under snow and ice conditions.

- Granular material in general, granulated and powdered fertiliser, sand, salt, gravel, etc.

The equipment must be carefully cleaned when changing the product. Grain size up to 5 mm.

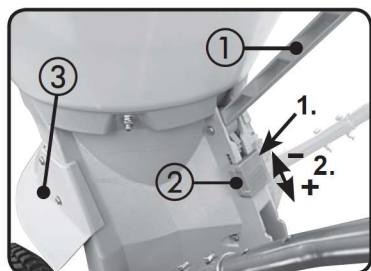

Spreading quantity is set using a lever ①. The spread volume can be varied via slider ②.

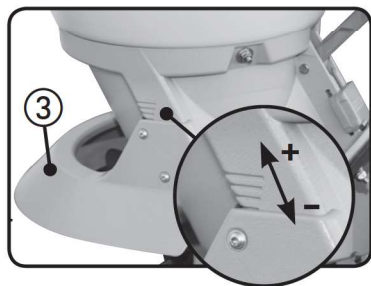

The spread width can be varied at the SW 20-C and SW 35-C via the adjustable spread width limiter ③.

Note on care

Material and quality:

All CEMO spreaders SW 20-C and SW 35-C are made from plastic and stainless steel. Contrary to the frequently used designation "rustproof", the formation of rust can never be entirely ruled out for stainless steel either. This material merely corrodes less readily. Depending on the alloy used, the stainless steel can be highly rust resistant but very soft (cf. kitchen utensils) or less rust resistant but very hard.

Corrosion/rust spots:

Corrosion or rust spots result from poor care or improper use. Your spreader should be cleaned, dried and oiled at regular intervals to prevent rust and corrosion. This is very important if you use your spreader in a damp environment or in connection with road salt. After cleaning, you should treat the moving parts in particular with a light, rust-dissolving or water-displacing oil (e.g. WD-40). Polish the surfaces with a non-metallic scouring cloth or a soft brush.

Cleaning methods:

Depending on the materials with which your spreader came into contact, there are various cleaning methods:

- If your spreader came into contact with road salt or salt water, it must be carefully rinsed with fresh water, dried and treated with a water-displacing product.
- If dirt or sticky substances have accumulated, clean your spreader with a solution of mild detergent and water.
- To remove tar and similar substances, clean your spreader with turpentine or methylated spirit. Do not use any products containing chlorine.
- Carefully dry your spreader after cleaning and oil it with a light, rust-dissolving or water-dispersing oil (e.g. WD-40) or a water-repelling product. Pay particular attention to ensure that no water remains in the moving parts, which could lead to corrosion.

Tyre pressure SW 20-C and SW 35-C:

The tyre pressure must be checked at regular intervals. The pressure should be set to 2.0 bar (29 psi). This ensures optimal wheel traction.

Technical data

Hopper content	Weight	Dimensions			Spread width		
		Height	Width	Length	Grit/sand/salt		
l	kg/lbs	kg/lbs	cm/in	cm/in	cm/in	m	ft
SW 20-C / SW 20-light							
19	23/50	9/19,5	70/27,6	50/19,7	43/17	1 - 4	3 1/3 - 13
SW 35-C							
32	35/76	9,5/20,5	72/28,3	52/20,5	52/20,5	1 - 4	3 1/3 - 13