

Installation guidelines

litter bins

Viscount



Cleaning Products should be flushed with clean water and then washed with a mild detergent solution using a bristle brush or sponge. Care should be taken not to apply undue pressure that may damage labels. Flush clean with water after washing.



Manufacturing Standard (as applicable)
All products are manufactured to BS EN ISO 9002.
Plastic materials: Mechanical properties tested to BS 2782 Hot dipped galvanized: BS 729
Powder coating: BS 3900 Zinc coating: BS 1706



Tools Chalk, hammer drill, 12mm masonry drill bit, mallet, 17mm socket,
Key:

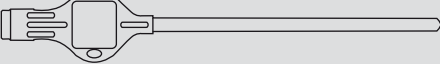

PPE Always wear appropriate PPE equipment and follow safety guidelines

Preparation



Position the ballast cartridge so that the locking pin is at 45° in a clockwise direction from the direction that the lock on the bin will face



Using chalk, mark the position through the three holes onto the ground below



Remove ballast cartridge and clearly mark the ground in the three hole positions with a cross

Ground fixing kit and ballasting additional components: Available as optional extra.
Gravel for ballasting should be supplied by the contractor

Ground fixing bolt

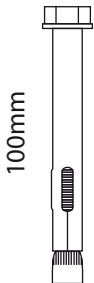

X3

Washer



X3

Ballast bung

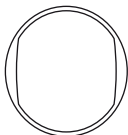

(fitted to ballast cartridge)

X1

Ground fixing to asphalt is not recommended

Removing and replacing liner



Grip liner using the two handles

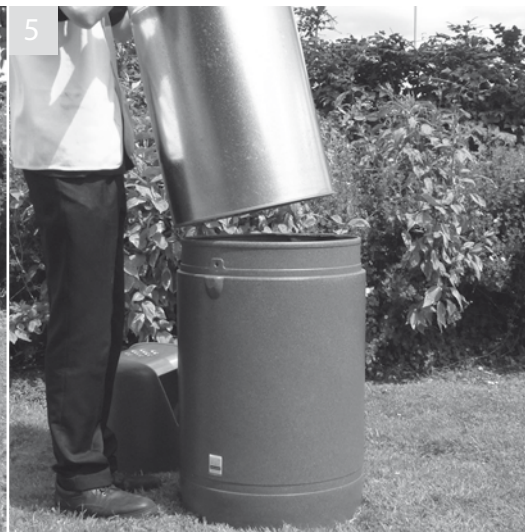

Lift liner upwards clearing the bin body and empty



Using handles to grip, replace liner

Replacing hood and locking



Replace bin top locating the bayonet and lock

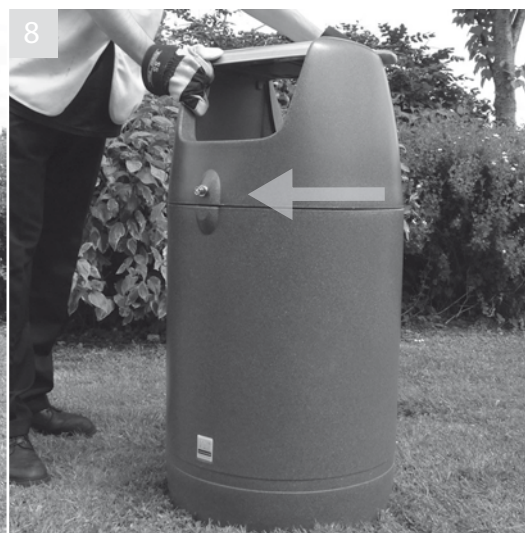

Twist top clockwise to align top with body

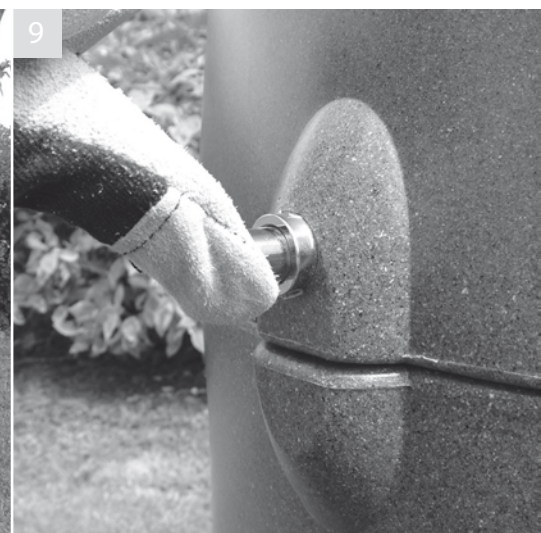

Push lock in to engage

Additional variations: Sack retention & ashtray



Stretch sack over bin body keeping liner edge above lip and taught. To remove liner pull the liner from the bin edge, gather and remove



To empty ashtray pull flap down releasing magnet - the contents will drop into the liner below



To close, push flap up engaging magnet