

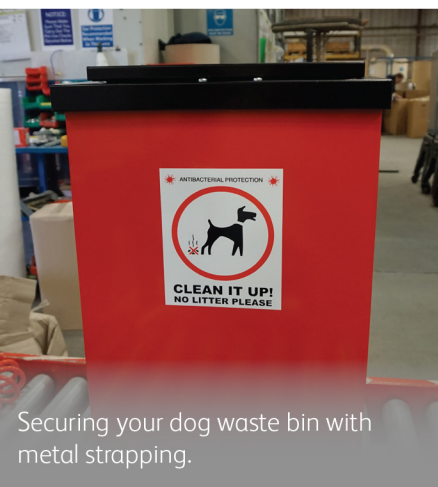

Kingfisher
Direct Ltd

Securing your dog waste bin



Securing your dog waste bin with metal strapping.



Brackets

Your bin will arrive with 2 brackets attached.

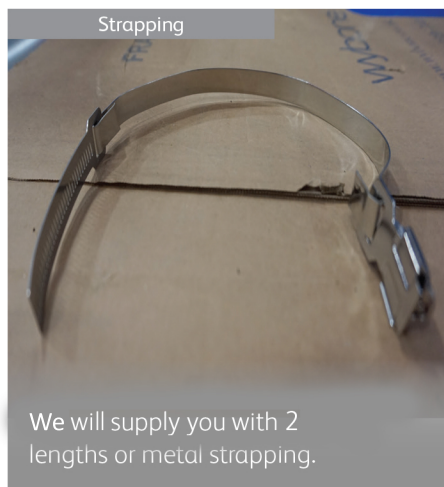

Strapping

We will supply you with 2 lengths of metal strapping.

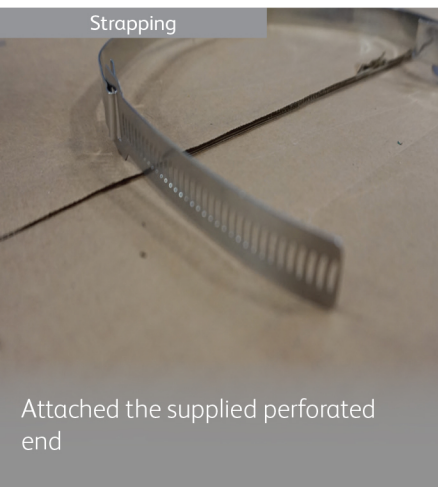

Strapping

Attached the supplied perforated end

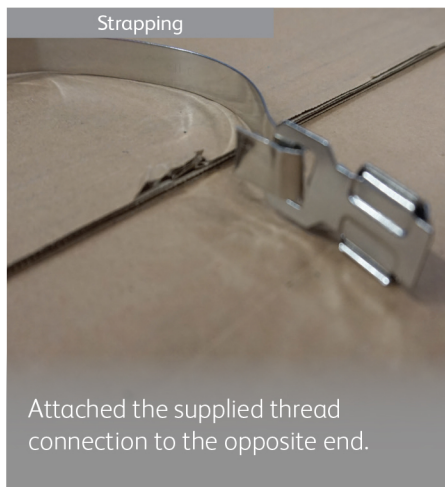

Strapping

Attached the supplied thread connection to the opposite end.

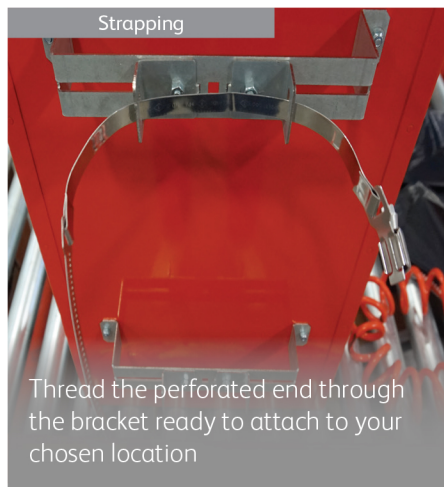

Strapping

Thread the perforated end through the bracket ready to attach to your chosen location

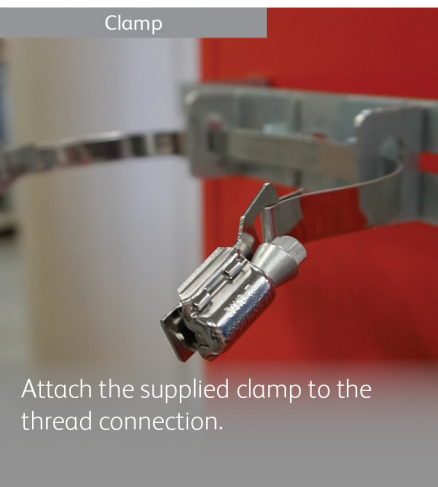

Clamp

Attach the supplied clamp to the thread connection.

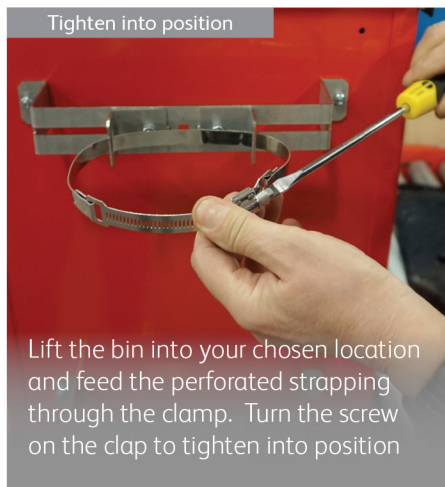

Tighten into position

Lift the bin into your chosen location and feed the perforated strapping through the clamp. Turn the screw on the clasp to tighten into position

